

Thrive Hearing Control Application

Basic

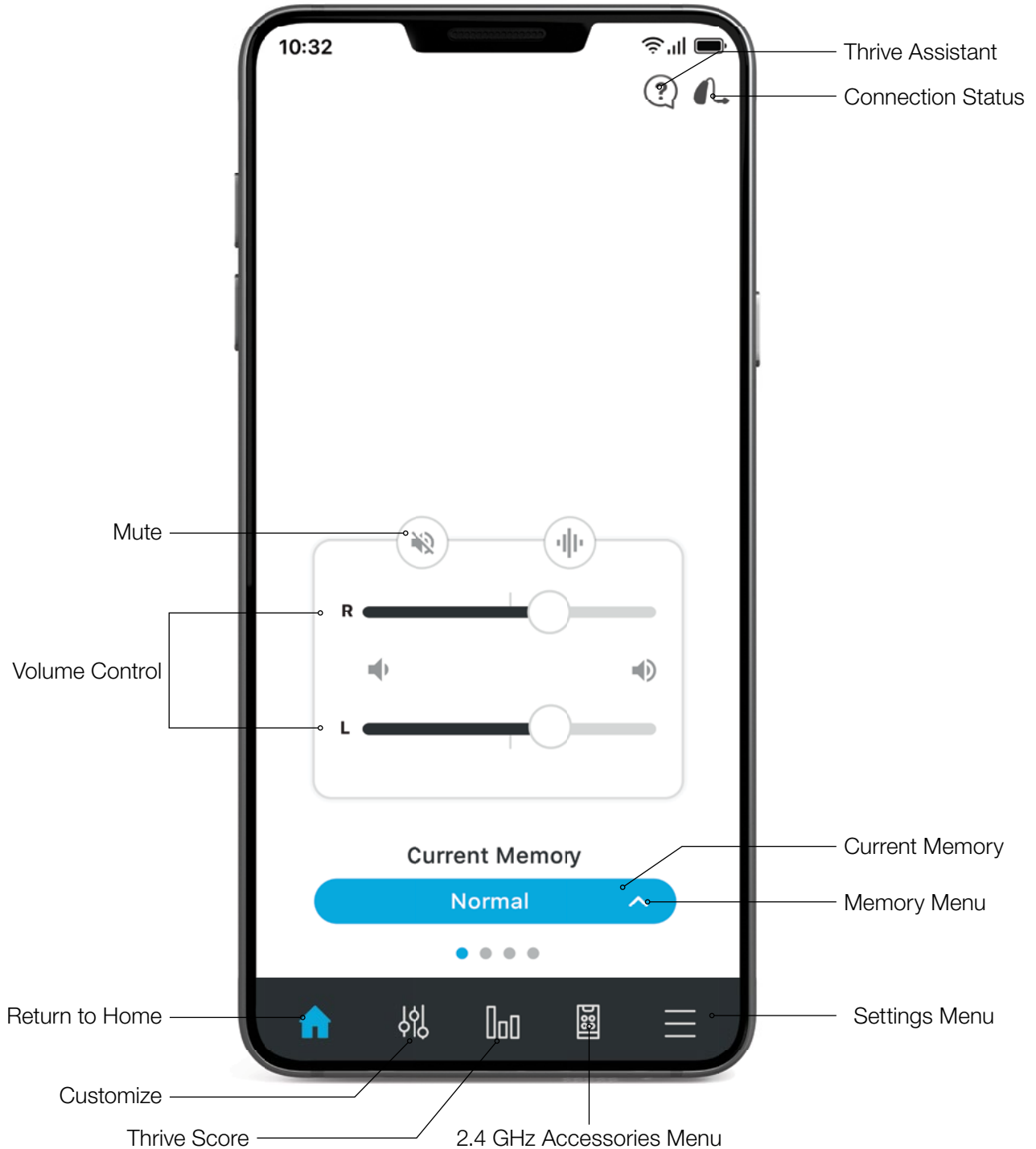

Hearing Aid Memories

Create a New Memory

Select the memory that provides the best sound quality for the current listening environment. Selected memory is the baseline for adjustments.

To create a custom memory, go to:

- 1 **Memory Menu**
- 2 **+ Create New Memory**
- 3 **Memory Name**
- 4 **Location Settings**
- 5 **Set Location:**

Pin sets to current location.
Tap  (bottom of the map) to assign a geotag.

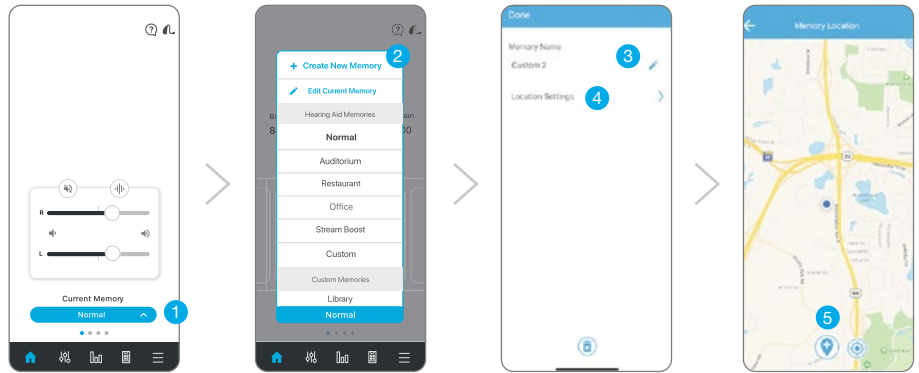

“Temp” Any adjustment to a memory that was set by the hearing professional within Inspire X will automatically save as “Temp”. Tap the Memory menu, then select  **Edit Current Memory** to name and save in the custom memories list for future use.

Smart VC Volume position is saved and set for custom memories to provide a more consistent user experience.

Customize a Memory

For additional customization, select **Customize**  from the navigation bar. The Equalizer can be adjusted as desired for additional memory fine tuning.

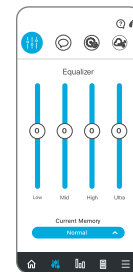

Equalizer

Adjust equalizer sliders for additional memory fine tuning.

Tinnitus

Adjust the volume and modulation speed of the tinnitus stimulus in memories that have been configured for tinnitus or in custom memories based on those memories. The tinnitus screen will be visible in the Thrive Hearing Control app if the hearing professional has enabled the tinnitus stimulus in the active memory.

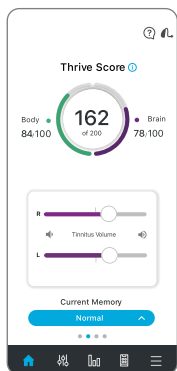

Adjusting Tinnitus Stimulus Volume

Adjust tinnitus stimulus volume individually or slide finger in the gray area to adjust binaurally. Double tap to return to the default stimulus volume.

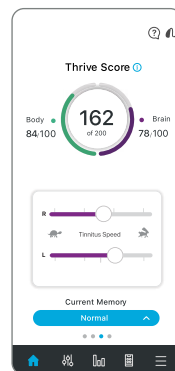

Adjusting Tinnitus Speed

Drag the circle icon along right or left sliders to adjust from no modulation to fast modulation.

CROS System

Adjust the balance of sound coming from the Transmitter relative to the Receiver in memories that have been configured for BiCROS or in custom memories based on those memories. The Balance screen will be visible in the Thrive app if the hearing professional has enabled BiCROS in the active memory.

- Drag the circle icon along the slider to adjust the balance of sound coming from the Transmitter relative to the Receiver.
- Tap “Mute Transmitter” to mute the Transmitter.

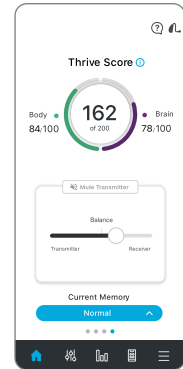

Thrive Assistant

Thrive Assistant¹ is an app-based assistant providing hands-free help whenever and wherever needed. Users can conveniently ask questions, troubleshoot hearing aid and accessory issues or simply say a command to change hearing aid volume or memories.

- 1 To access, tap the Thrive Assistant icon  in the top right corner of the Thrive app. AI users can also double tap their hearing aid to access Thrive Assistant if set as a user control by the hearing professional within Inspire X.
- 2 Thrive Assistant will indicate “Listening, please ask your question.”
- 3 State a command or ask a question. Thrive Assistant will execute the command or will search for and return an appropriate answer to the question from the Thrive help files or cloud-based services.



Other

In addition, Settings include:

- User Guide
- Device Settings
- Find My Hearing Aids
- About
- Demo Mode
- App Settings:
 - Advanced/Basic Mode

Basic Mode does not include:

- Thrive Score
- Additional memory customization beyond Equalizer
- Fall Alert
- Transcribe
- Accessory Screen
- Translate
- Hearing Care Anywhere
- Reminders
- Self Check

Features may vary by country.

¹Thrive Assistant is available only on premium 2.4 GHz hearing aids on the Thrive platform.

The Starkey logo, Thrive, Inspire and Hearing Care Anywhere are trademarks of Starkey Laboratories, Inc.

The app may have slight differences depending on your phone.

©2020 Starkey. All Rights Reserved. 1/20 FLYR3474-01-EE-SG